

# GIBBES MUSEUM OF ART | VISITOR MAP

## 1ST FLOOR

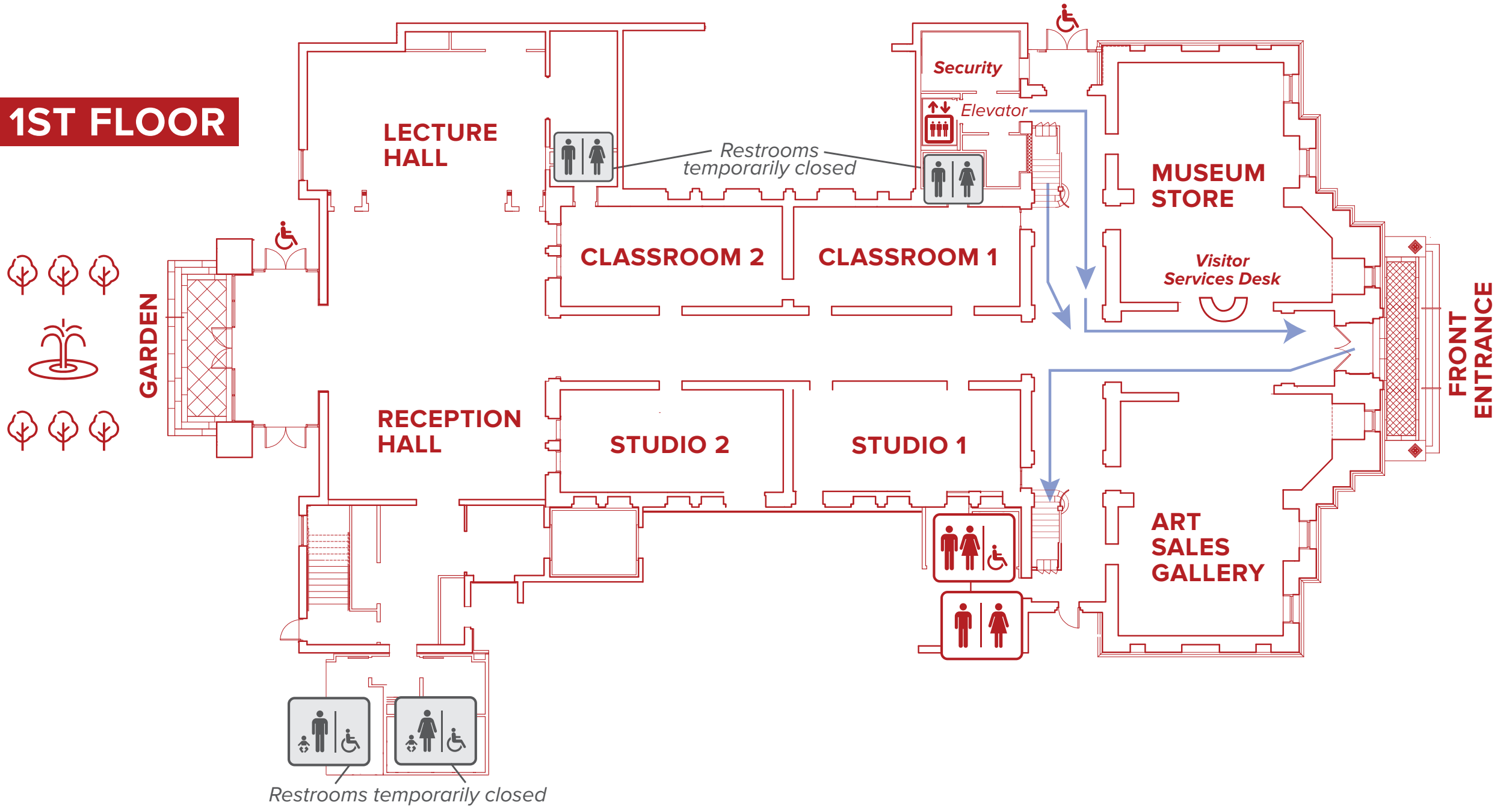

## 2ND FLOOR

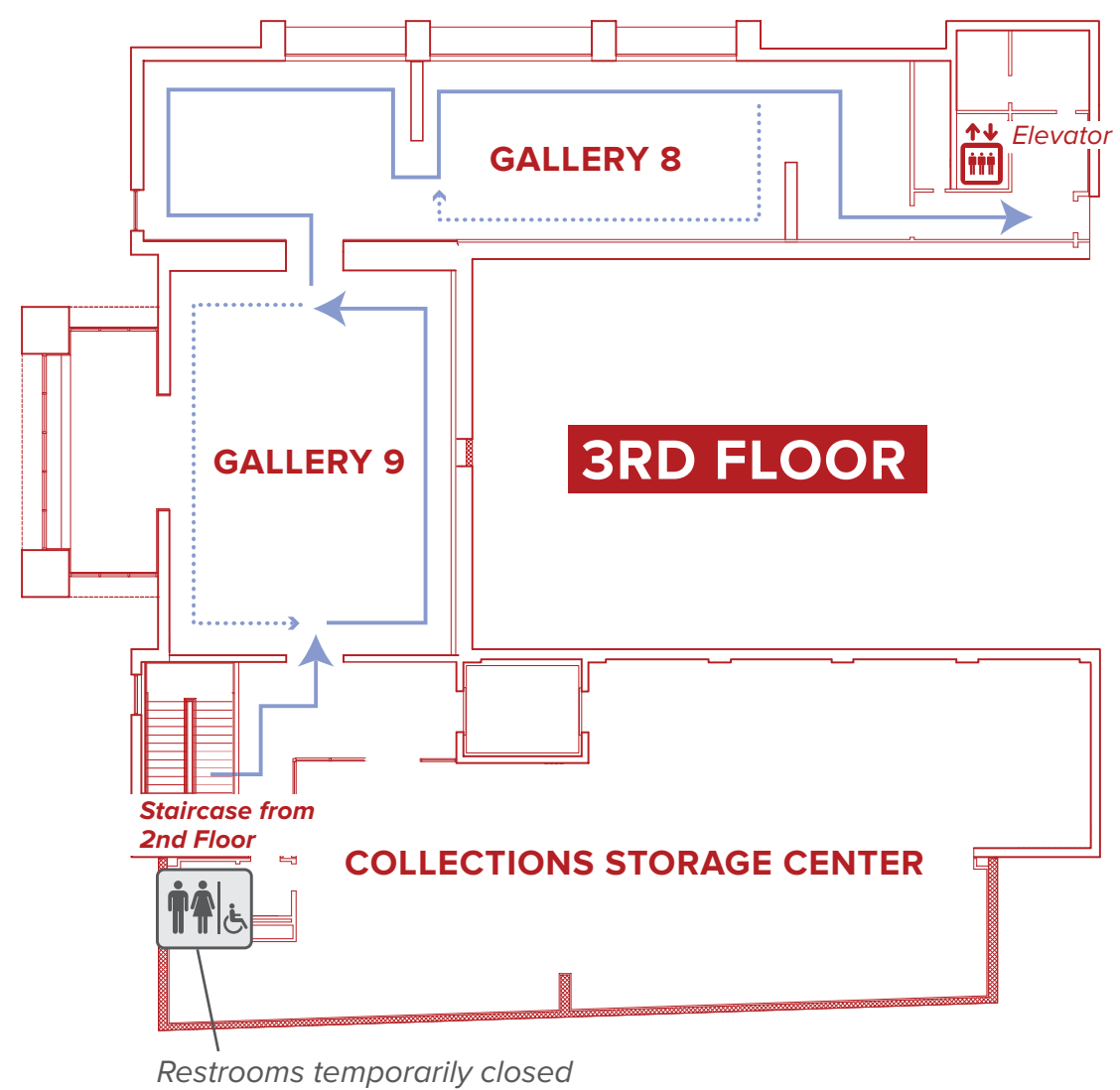
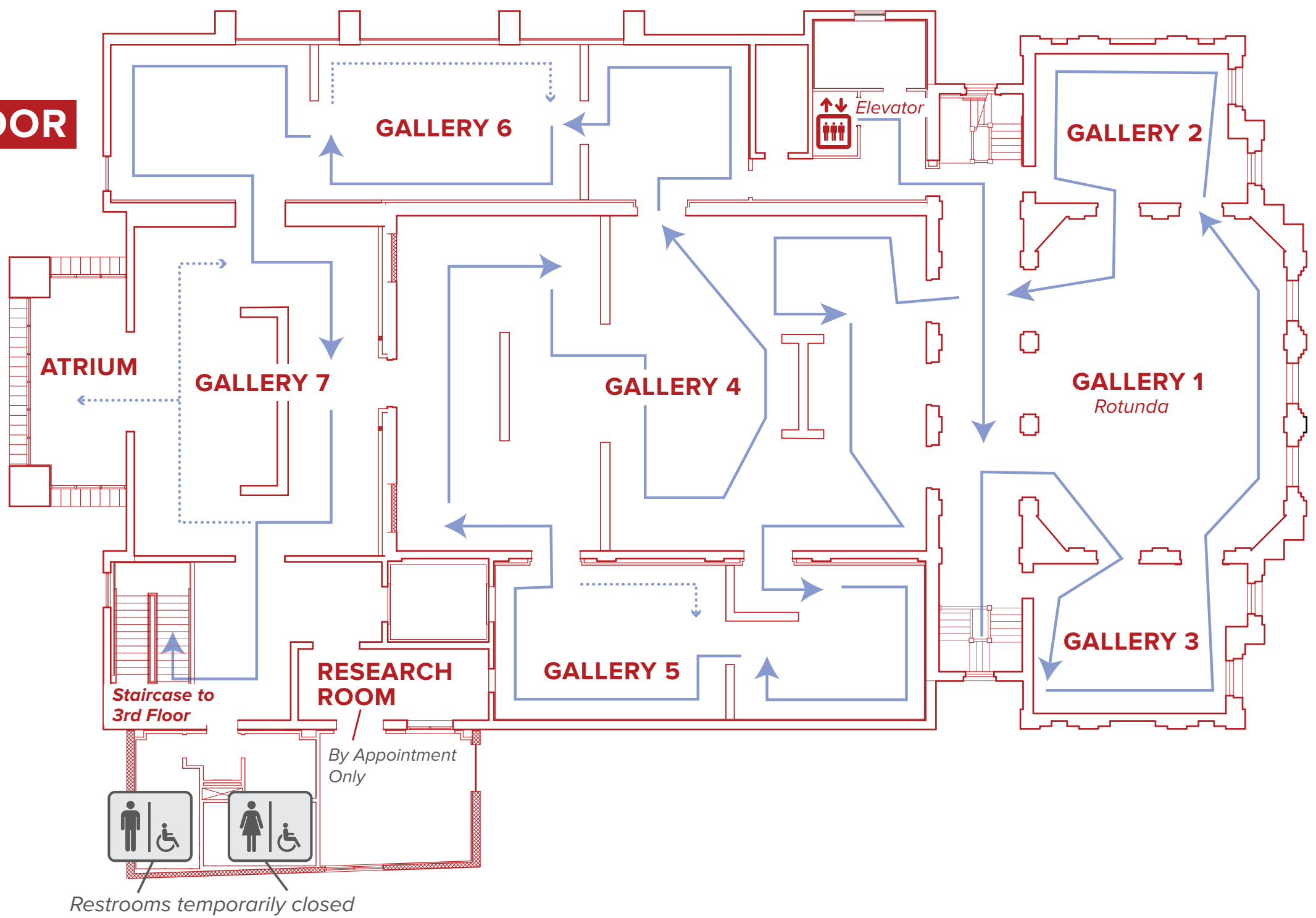

CURRENT EXHIBITIONS | NOW ON VIEW

### PERMANENT COLLECTION - 2ND FLOOR

- |  |  |
|--|--|
| <b>18th and 19th Century American Paintings and Sculpture</b><br>Galleries 1, 4, 5 | <b>20th Century American Regionalism and the Charleston Renaissance</b><br>Gallery 6 |
| <b>Miniature Portraits</b><br>Gallery 5  | <b>Modern and Contemporary Art</b><br>Gallery 7                                      |

### SPECIAL EXHIBITIONS - 2ND FLOOR

**Charleston Collects: British Sporting Art from the Penkhys Collection**  
February 7, 2020 – October 4, 2020  
Galleries 2 & 3

### SPECIAL INSTALLATION

**Betwixt and Between** by Patrick Dougherty  
on view through April 2021 | 2nd Floor Atrium

### SPECIAL EXHIBITIONS - 3RD FLOOR

**Building a Legacy: The Vibrant Vision Collection of Jonathan Green and Richard Weedman**  
August 21, 2020 – January 10, 2021  
Gallery 8

**A Return to the Grand Tour: Micromosaic Jewels from the Collection of Elizabeth Locke**  
January 17, 2020 – January 10, 2021  
Gallery 9

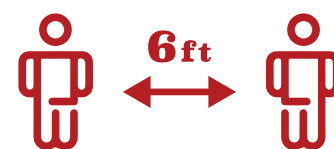

THANK YOU FOR PRACTICING SOCIAL DISTANCING! PLEASE FOLLOW OUR MAP DURING YOUR VISIT AND MAINTAIN A 6-FOOT DISTANCE FROM OTHERS.

the Gibbes museum of art

# THANK YOU FOR PRACTICING SOCIAL DISTANCING

*A few reminders during your visit:*



visitors and Gibbes team members are required to wear face masks, for the safety of everyone

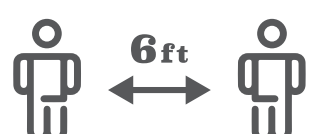

maintain a 6-foot distance from others



sneeze and cough into a cloth or tissue



do not shake hands or engage in any unnecessary physical contact



hand sanitizer stations are provided throughout the Museum for your convenience



antiviral sweeps are conducted every hour to ensure that all touched surfaces are routinely sanitized



restrooms are located on the first floor near the front entrance; all other restrooms are temporarily closed



the garden and first floor classrooms are temporarily closed during Gibbes Summer Camp



*Thank you for understanding!*  
— YOUR GIBBES FAMILY



## APPLY TODAY'S ADMISSION TOWARD A MEMBERSHIP

Enjoy free admission today and tons of great benefits all year long!

*Inquire at the Visitor Services Desk for more information.*



## FREE WIFI

NETWORK:  
**GibbesGuest**

PASSWORD:  
**Gma1680!**



## THE GIBBES MOBILE APP

Download the Gibbes Museum App at [gibbesmuseum.org/app](https://gibbesmuseum.org/app) to learn more about the Gibbes collection and special exhibitions.



tripadvisor®

Please take a moment to share your Gibbes experience by writing a quick review on **TripAdvisor!**



*Please note: Visitors are required to adhere to the posted social distancing guidelines, which reflect current CDC and OSHA recommendations. We reserve the right to remove any person that does not follow these guidelines.*

#ArtIsTheReason

MUSEUM HOURS: MONDAY-SATURDAY 10AM-5PM | SUNDAY 1-5PM  
135 MEETING STREET | CHARLESTON, SC 29401 | 843.722.2706

    
@theGibbesmuseum

GIBBESMUSEUM.ORG

the  
Gibbes  
museum  
of art

